

Technical Document RA25015



Part 2 – Technical Requirements

Application under the *Agricultural Operation Practices Act* for a confined feeding operation, manure collection area, and/or manure storage facility(ies)

NRCB USE ONLY	Application number RA25015	Legal land description NW 16-42-26 W4M
<input type="checkbox"/> Approval <input type="checkbox"/> Registration <input checked="" type="checkbox"/> Authorization <input type="checkbox"/> Amendment		

APPLICATION DISCLOSURE

This information is collected under the authority of the *Agricultural Operation Practices Act (AOPA)*, and is subject to the provisions of the *Freedom of Information and Protection of Privacy Act*. This information is public unless the NRCB grants a written request that certain sections remain private.

Any construction prior to obtaining an NRCB permit is an offence and is subject to enforcement action, including prosecution.

I, the applicant, or applicant's agent, have read and understand the statements above, and I acknowledge that the information provided in this application is true to the best of my knowledge.

February 21, 2025
Date of signing
Pleasant Hill Farms Ltd
Corporate name (if applicable)

Signature
Karen Pierik
Print name

GENERAL INFORMATION REQUIREMENTS

Proposed facilities: list all proposed confined feeding operation facilities and their dimensions. Indicate whether any of the proposed facilities are additions to existing facilities. (attach additional pages if needed)	
Proposed facilities	Dimensions (m) (length, width, and depth)
Modifying old milking parlor to free stalls	14m x 10m

Existing facilities: list ALL existing confined feeding operation facilities and their dimensions		
Existing facilities	Dimensions (m) (length, width, and depth)	NRCB USE ONLY
Listed on next page		All existing facilities confirmed

NRCB USE ONLY AO Comment: CFO is permitted under Approval RA08002 and Authorizations RA13040, RA16051, RA18033, and RA21039.
--

Part 2 – Technical Requirements

Application under the Agricultural Operation Practices Act for a confined feeding operation, manure collection area, and/or manure storage facility(ies)

Existing facilities continued	Dimensions (m) (length, width, and depth)	NRCB USE ONLY
Free stall Barn	102.4 x 26.2	
Loading barn	48.8 x 26.2	
Young Stock Shelters & Corral	71.9 x 79.2	
Lagoon	58 x 43 x 7	
Unbuilt Concrete pad	27.5 x 19	
Loading barn Addition	53.6 x 26.2	
Parlor	21.3 x 19.5	
Holding area	20.1 x 26.2	
Pit under alley from existing barn to hold	4.9 x 35.4	
EMS	75 x 70 x 6	
Dry Cow Barn	45.72m x 21.34m	
Dry Cow Barn Addition	45.72m x 21.34m	

Part 2 – Technical Requirements

Application under the *Agricultural Operation Practices Act* for a confined feeding operation, manure collection area, and/or manure storage facility(ies)

If a new facility is replacing an old facility, please explain what will happen to the old facility and when. N/A

Old Milking parlour area is being converted to a freestall area.

Construction completion date for proposed facilities _____ Spring / Summer 2025

Additional information

Livestock numbers: Complete only if livestock numbers are different from what was identified in the Part 1 application. Note: if livestock numbers increase in your Part 2 application, a new Part 1 application must be submitted which may result in a loss of priority for minimum distance separation (MDS).

Livestock category and type <small>(Available in the Schedule 2 of the Part 2 Matters Regulation)</small>	Permitted number	Proposed increase or decrease in number <small>(if applicable)</small>	Total
<u>No increase in animal numbers</u>			

Part 2 – Technical Requirements

Application under the *Agricultural Operation Practices Act* for a confined feeding operation, manure collection area, and/or manure storage facility(ies)

DECLARATION AND ACKNOWLEDGMENT OF APPLICANT CONCERNING WATER ACT LICENCE

issued by Alberta Environment and Protected Areas (EPA) for a confined feeding operation (CFO)

Date and sign one of the following four options

OPTION 1: Applying through the NRCB for both the AOPA permit and the Water Act licence

I **DO** want my water licence application coupled to my AOPA permit application.

Signed this ____ day of _____, 20____.

Signature of Applicant or Agent

OPTION 2: Processing the AOPA permit and Water Act licence separately

1. I (we) acknowledge that the CFO will need a new water licence from EPA under the *Water Act* for the development or activity proposed in this AOPA application.
2. I (we) request that the NRCB process the AOPA application **independently of** EPA's processing of the CFO's application for a water licence.
3. In making this request, I (we) recognize that, if this AOPA application is granted by the NRCB, the NRCB's decision will not be considered by EPA as improving or enhancing the CFO's eligibility for a water licence under the *Water Act*.
4. I (we) acknowledge that any construction or actions to populate the CFO with livestock pursuant to an AOPA permit in the absence of a *Water Act* licence will **not** be relevant to EPA's consideration of whether to grant the *Water Act* licence application.
5. I (we) acknowledge that any such construction or livestock populating will be at the CFO's sole risk if the *Water Act* licence application is denied or if the operation of the CFO is otherwise deemed to be in violation of the *Water Act*. This risk includes being required to depopulate the CFO and/or to cease further construction, or to remove "works" or "undertakings" (as defined in the *Water Act*).
6. **AS RELEVANT:** I (we) acknowledge that the CFO is located in the South Saskatchewan River Basin and that, pursuant to the *Bow, Oldman and South Saskatchewan River Basin Water Allocation Order* [Alta. Reg. 171/2007], this basin is currently closed to new surface water allocations.
7. **Provide:** Water licence application number(s) _____

Signed this ____ day of _____, 20____.

Signature of Applicant or Agent

OPTION 3: Additional water licence not required

1. I (we) declare that the CFO will not need a new licence from EPA under the *Water Act* for the development or activity proposed in this AOPA application.
2. **Provide:** Water license number(s) or water conveyance agreement details _____

Well IDs: 286665 and 2088704

Signed this 21 day of February, 2025.

Signature of Applicant or Agent

Part 2 – Technical Requirements

Application under the *Agricultural Operation Practices Act* for a confined feeding operation, manure collection area, and/or manure storage facility(ies)

OPTION 4: Uncertain if *Water Act* licence is needed; acknowledgement of risk (for existing CFOs only)

1. At this time, I (we) do not know whether a new water licence is needed from EPA under the *Water Act* for the development or activity proposed in this AOPA application.
2. If a new *Water Act* licence is needed, I (we) request that the NRCB process the AOPA application **independently of** EPA's processing of the CFO's application for a water licence.
3. In making this request, I (we) recognize that, if this AOPA application is granted by the NRCB, the NRCB's decision will not be considered by EPA as improving or enhancing the CFO's eligibility for a water licence under the *Water Act*.
4. I (we) acknowledge that any construction or actions to populate the CFO with additional livestock pursuant to an AOPA permit in the absence of a *Water Act* licence will **not** be relevant to EPA's consideration of whether to grant my *Water Act* licence application, if a new water licence is needed.
5. I (we) acknowledge that any such construction or livestock increase will be at the CFO's sole risk if the *Water Act* licence application is denied or if the operation of the CFO is otherwise deemed to be in violation of the *Water Act*. This risk includes being required to depopulate the CFO and/or to cease further construction, or to remove "works" or "undertakings" (as defined in the *Water Act*).
6. **AS RELEVANT:** I (we) acknowledge that the CFO is located in the South Saskatchewan River Basin and that, pursuant to the *Bow, Oldman and South Saskatchewan River Basin Water Allocation Order* [Alta. Reg. 171/2007], this basin is currently closed to new surface water allocations.
7. **Provide:** Water license number(s) or water conveyance agreement details _____

Signed this ____ day of _____, 20____.

Signature of Applicant or Agent

Proposed Plan (Detailed Site layout plan 1)

Google Maps google earth NW-16-42-26-W4



20m
SCALE

■ = Old parlor being proposed to change to free stalls (inside of current barn)

Legend

▨ - Existing Dry Cow Barn

▤ - EMS (existing facility)

▥ - Lagoon (existing facility)

▧ - Freestall barn (existing facility)

▩ - Loading barn & Loading barn addition (existing facility)

▪ - Parlor & Holding Area (existing facility)

□ - Addition to Existing Dry Cow Barn

* = water well

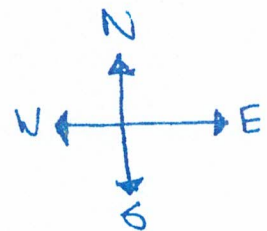

Part 2 – Technical Requirements



Application under the *Agricultural Operation Practices Act* for a confined feeding operation, manure collection area, and/or manure storage facility(ies)

GENERAL ENVIRONMENTAL INFORMATION

(Complete this section for the worst case of the existing facility which is the closest to water bodies or water wells and for each of the proposed facilities)

Facility description / name *(as indicated on site plan)*

Existing: Loading Barn

Proposed 1: Old parlour to freestalls

Proposed 2: _____

Proposed 3: _____

Facility and environmental risk information		Facilities				NRCB USE ONLY	
		Existing	Proposed 1	Proposed 2	Proposed 3	Meets requirements	Comments
Flood plain information	What is the elevation of the floor of the lowest manure storage or collection facility above the 1:25 year flood plain or the highest known flood level?	<input checked="" type="checkbox"/> >1 m <input type="checkbox"/> ≤ 1 m	<input checked="" type="checkbox"/> >1 m <input type="checkbox"/> ≤ 1 m	<input type="checkbox"/> >1 m <input type="checkbox"/> ≤ 1 m	<input type="checkbox"/> > 1 m <input type="checkbox"/> ≤ 1 m	<input checked="" type="checkbox"/> YES <input type="checkbox"/> NO <input type="checkbox"/> YES with exemption	Not in a known flood plain
	How many springs are within 100 m of the manure storage facility or manure collection area?	None	None			<input checked="" type="checkbox"/> YES <input type="checkbox"/> NO <input type="checkbox"/> YES with exemption	None observed from site visit
Surface water information	How many water wells are within 100 m of the manure storage facility or manure collection area?	1	1			<input type="checkbox"/> YES <input type="checkbox"/> NO <input checked="" type="checkbox"/> YES with exemption	1 water well located within 100 m of existing freestall barn. Conversion occurring within barn footprint
	What is the shortest distance from the manure collection or storage facility to a surface water body? (e.g., lake, creek, slough, seasonal)	1600m	1560m			<input checked="" type="checkbox"/> YES <input type="checkbox"/> NO <input type="checkbox"/> YES with exemption	>1,000 m to Wolf Creek from EMS
	What is the depth to the water table?		>6m			<input checked="" type="checkbox"/> YES <input type="checkbox"/> NO <input type="checkbox"/> YES with exemption	Measured at 6 m below grade
Groundwater information	What is the depth to the groundwater resource/aquifer you draw water from?	63m	63m			<input checked="" type="checkbox"/> YES <input type="checkbox"/> NO <input type="checkbox"/> YES with exemption	UGR measured at 21.4 m below grade in WW ID# 286665

Additional information (attach supporting information, e.g. borehole logs, records, etc. you consider relevant to your application)

Numbers from previous application records

Part 2 – Technical Requirements

Application under the *Agricultural Operation Practices Act* for a confined feeding operation, manure collection area, and/or manure storage facility(ies)

NRCB USE ONLY

WATER WELL AND SURFACE WATER INFORMATION

Well IDs: 286665 2088704

Surface water related concerns from directly affected parties or referral agencies: YES NO

Groundwater related concerns from directly affected parties or referral agencies: YES NO

Water wells N/A

If applicable, exemption for 100 m distance requirements applied: YES NO Condition required: YES NO

Surface water N/A

If applicable, exemption for 30 m distance requirements applied: YES NO Condition required: YES NO

Water Well Exemption Screening Tool N/A

Water Well ID	Preliminary Screening Score	Secondary Screening Score	Facility
286665	13	5	Freestall barn

Groundwater or surface water related comments:

Preliminary screening score 10-28: Continue to next section

Secondary screening score 4-19: Exemption more likely

AO Comment: Water well exemption was only completed for the freestall barn, as that is the only facility being renovated in this application. The exemption that was issued for the other facilities as part of Approval RA08002 is still valid.

Part 2 – Technical Requirements

Application under the *Agricultural Operation Practices Act* for a confined feeding operation, manure collection area, and/or manure storage facility(ies)

NRCB USE ONLY
ENVIRONMENTAL RISK SCREENING INFORMATION

ERST for **proposed** facilities

Facility	Groundwater score	Surface water score	File number
Conversion of existing milk parlour to freestalls	Low	Low	RA25015

ERST for **existing** facilities

Facility	Groundwater score	Surface water score	File number
Addition to dry cow barn	Low	Low	RA21039
Dry cow barn	Low	Low	RA21039
Old EMS	Low	Low	RA13040
Loafing barn/freestall solid portion	Low	Low	RA13040
New EMS	Low	Low	RA13040
Loafing barn (addition with pits)	Low	Low	RA13040
Holding area	Low	Low	RA13040
Free Stall Barn	Low	Low	RA13040

ERST related comments:

Part 2 – Technical Requirements

Application under the *Agricultural Operation Practices Act* for a confined feeding operation, manure collection area, and/or manure storage facility(ies)

DISTANCE OF ANY MANURE STORAGE FACILITY (EXISTING OR PROPOSED) TO NEIGHBOURING RESIDENCES

Neighbour name(s)	Legal land description	Distance (m)	NRCB USE ONLY				
			Zoning (LUB) category	MDS category (1-4)	Distance (m)	Waiver attached (if required)	Meets regulations
1 Jeff Harriman	NE-17-42-26-W4	400	Agriculture	1	440		Yes
2 Greg Bowie	SW-21-42-26-W4	398.25	Agriculture	1	398.25		Yes
3 Earl Dowling	SE-20-42-26-W4	454	Agriculture	1	440		Yes
Pleasant Hills Subdivision	NW-10-42-26-W4	1820	Country Res	4	1,854		Yes

LAND BASE FOR MANURE AND COMPOST APPLICATION (complete only if an increase in livestock or manure production will occur)

Name of land owner(s)*	Legal land description	Usable area** (ha)	Soil zone ***	NRCB USE ONLY	
				Usable area (ha)	Agreement attached (if required)
N/A					
Total					

* If you are **not** the registered landowner, you must attach copies of land use agreements signed by all landowners.

** Available manure spreading area (excluding setback areas from residences, common bodies of water, water wells, etc. as identified in Agdex 096-5 [Manure Spreading Regulations](#))

*** Brown, dark brown, black, grey wooded, or irrigated

Additional information (attach any additional information as required)

AO Comment: Numbers next to neighbour list correspond with numbers on the map on the next page; Distance from CFO measured to closest residence on NW 10-42-26 W4 (Pleasant Hills Subdivision)

Area Plan (Aerial Picture)

Google Maps google earth - Ponoka County

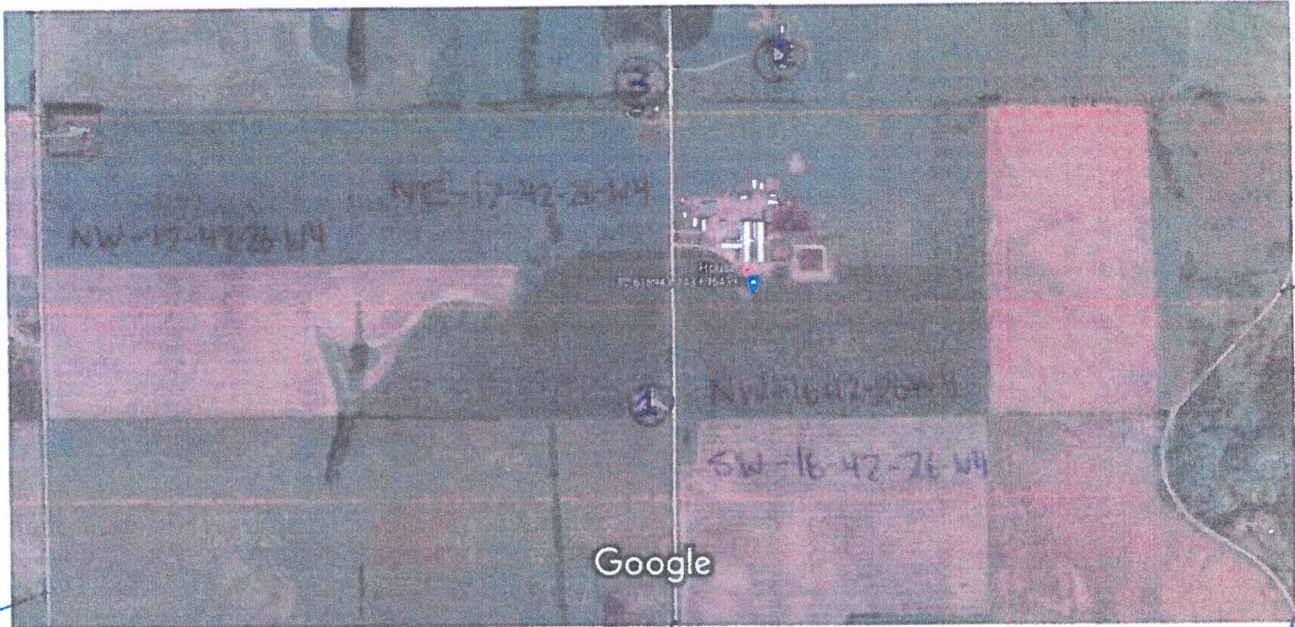

Imagery ©2018 Google, Map data ©2018 Google



Range Road 265

Range Road 264

Range Road 263

Neighboring Residences

- ① - Jeff Harriman
- ② - Greg Bowie
- ③ - Earl Dowling

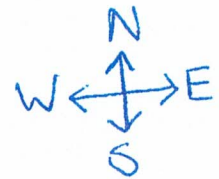

Part 2 – Technical Requirements

Application under the *Agricultural Operation Practices Act* for a confined feeding operation, manure collection area, and/or manure storage facility(ies)

NRCB USE ONLY

MINIMUM DISTANCE SEPARATION

Methods used to determine distance (if applicable): Google Earth

Margin of error (if applicable): +/- 2 m

Requirements (m): Category 1: 346 Category 2: 461 Category 3: 577 Category 4: 923

Technology factor: YES NO

Expansion factor: YES NO

MDS related concerns from directly affected parties or referral agencies: YES NO

LAND BASE FOR MANURE AND COMPOST APPLICATION

Land base required: _____ N/A for authorizations

Land base listed: _____

Area not suitable: _____

Available area: _____

Requirement met: YES NO

Land spreading agreements required: YES NO

Manure management plan: YES NO

If yes, plan is attached:

PLANS

Submitted and attached construction plans: YES NO

Submitted aerial photos: YES NO

Submitted photos: YES NO

GRANDFATHERING

Already completed: YES NO N/A

If already completed, see Approval RA08002

Part 2 – Technical Requirements

Application under the Agricultural Operation Practices Act for a confined feeding operation, manure collection area and/or manure storage facility(ies)

LIQUID MANURE COLLECTION AND/OR STORAGE: In-barn - Concrete liner

(complete a copy of this section for EACH proposed in-barn liquid manure storage facility with a concrete liner)

Facility description / name (as indicated on site plan)

1. Converting Old Milking Parlour to Freestalls
2. _____
3. _____

Manure storage capacity (use one row in the table for EACH in-barn storage. Attach additional pages if you require more rows)

	Length (m)	Width (m)	Total depth (m)	Depth below ground level (m)	NRCB USE ONLY
					Calculated storage capacity (m ³)
1.	14m	10m	6inch curbs	Aboveground	
2.					
3.					
TOTAL CAPACITY					

Concrete liner details

Scrape alleys or unslatted portions of barn floors (if applicable)	Concrete thickness		Method of sulphate protection		
	Minimum 5" thick		Type 50		
	Concrete strength		Concrete reinforcement size and spacing		
	Minimum 32 Mpa (@ 56 days)		10M rebar max spacing at 16 inches		
In-barn manure pit floors No additional pits added	Concrete thickness		Method of sulphate protection		
In-barn manure pit walls No additional pits added	Concrete strength		Horizontal reinforcement size and spacing		Vertical reinforcement size and spacing

Part 2 – Technical Requirements

Application under the *Agricultural Operation Practices Act* for a confined feeding operation, manure collection area and/or manure storage facility(ies)

LIQUID MANURE COLLECTION AND/OR STORAGE: In-barn - Concrete liner (cont.)

Describe how the joints at the junction of the pit walls, pit floors and any other joints will be sealed

- Water stop, caulked joints, expanding caulked joint

Describe sealing practices for piping, etc. that penetrates the liner

- Expanding caulked joints, piping boots. cast in place

Concrete requirements can be found in Technical Guideline Agdex 096-93

Guideline minimums:
Solid manure: 25MPa (D)
Solid manure (wet): 30MPa (C)
Liquid manure: 32MPa (B)
Category A is required to be engineered
Method of sulphate protection:
Type 50 or Type 10 with fly ash or equivalent

NRCB USE ONLY

Requirements met: YES NO

Condition required: YES NO

Additional information

NRCB USE ONLY

Liquid manure storage volume calculator attached: YES NO N/A no increase in livestock numbers

Depth to water table: 6 m below grade

Requirements met: YES NO

Depth to uppermost groundwater resource: 21.4 m below grade

Requirements met: YES NO

ERST completed: see ERST page for details

Concrete liner requirements

Leakage detection system required: YES NO If yes, please explain why

A condition is included in this authorization requiring the permit holder to provide written confirmation that the concrete liner meets the specifications for category C (solid manure - wet) as outlined in Technical Guideline Agdex 096-93 "Non-Engineered Concrete Liners for Manure Collection and Storage Areas."

Part 2 – Technical Requirements

Application under the *Agricultural Operation Practices Act* for a confined feeding operation, manure collection area, and/or manure storage facility(ies)

NRCB USE ONLY

ALL SIGNATURES IN FILE YES NO

DATES OF APPROVAL OFFICER SITE VISITS

March 12, 2025	

CORRESPONDENCE WITH MUNICIPALITIES AND REFERRAL AGENCIES

Date deeming letters sent: February 25, 2025

Municipality: Ponoka County

letter sent response received written/email verbal no comments received

Alberta Health Services: N/A

letter sent response received written/email verbal no comments received

Alberta Environment and Parks: N/A

letter sent response received written/email verbal no comments received

Alberta Transportation: N/A

letter sent response received written/email verbal no comments received

Alberta Regulatory Services: N/A

letter sent response received written/email verbal no comments received

ATCO Gas & Pipelines Ltd.

Other: _____ N/A

letter sent response received written/email verbal no comments received

Other: _____ N/A

letter sent response received written/email verbal no comments received